

REF. NO.	PART NO.	PART NAME	QTY.
1.	E49-1230	MAIN BEARING FLANGE.....	2
2.	E49-1220	MAIN THRUST BEARING W/LOCK RING.....	1
3.	E36-1712	ROTOR TACH MAGNET BRACELET.....	1
4.	E00-9028	HOSE CLAMP #28.....	2
5.	E49-1260	MAIN SHAFT SAFETY SPACER.....	1
6.	E00-3410	1/4 THIN LOCKNUT ALL METAL.....	5
7.	E49-8100	MAIN SPROCKET ASSEMBLY.....	1
8.	E49-7000	MAIN ROTOR SHAFT/HUB ASSEMBLY.....	1
9.	E00-3602	NUT 3/8 LOCKNUT ALL METAL.....	3
	E00-4600	WASHER 3/8 REGULAR AN960-616.....	6
10.	E00-2608	BOLT 3/8 X 3-1/8 CLOSE TOL.....	3
11.	E00-4851	WASHER 1-1/4 X 1-3/4.....	3
12.	E00-2450	BOLT AN4H12 (1/4 X 1-1/4).....	4
	E00-4400	WASHER 1/4 THIN AN960-416L.....	4
	E00-4401	WASHER 1/4 REGULAR AN960-416.....	4
13.	E49-1251	LOWER MAINSHAFT BEARING.....	1
14.	E49-9001	LOWER BEARING FLANGE WELDMENT.....	1
	E49-9100	MAIN SHAFT LOWER BEARING FLANGE.....	1
	E49-1246	MAIN SHAFT LOWER BRG. TOP FLANGE.....	1
15.	E00-2622	CARRIAGE BOLT 3/8-16 X 1.....	2
16.	E00-2531	BOLT 5/16 X 2-1/4 AN5-22A.....	2
17.	E00-2602	BOLT 3/8 X 1-1/8 AN6-11A.....	4
	E00-3600	NUT 3/8-24 FIBERLOCK AN365-624A.....	4
	E00-4600	WASHER 3/8 REGULAR AN960-616.....	8
18.	E00-2301	BOLT AN3-5A (3/16 X 5/8).....	2
	E00-3301	NUT 3/16 FIBERLOCK AN365-1032A.....	2
	E00-4301	WASHER 3/16 REGULAR AN960-10.....	4
19.	E49-1380	COLLECTIVE SCISSOR MOUNT.....	1
20.	E00-2434	EYE BOLT AN4-3B4A (1/4 X 1/2).....	1
21.	E49-8200	COG BELT TENSIONER ASSEMBLY.....	1
22.	E00-2301	BOLT AN3-5A (3/16 X 5/8).....	1
	E00-3301	NUT 3/16 FIBERLOCK AN365-1032A.....	1
	E00-4301	WASHER 3/16 REGULAR AN960-10.....	2
23.	E49-8490	TENSIONER STRAP.....	1
24.	E00-2320	BOLT AN3-14A (3/16 X 1-1/2).....	1
	E00-3301	NUT 3/16 FIBERLOCK AN365-1032A.....	1
	E00-4301	WASHER 3/16 REGULAR AN960-10.....	2
25.	E00-2522	BOLT AN5-30A (5/16 X 3).....	1
	E00-3500	NUT 5/16-24 FIBERLOCK AN365-524A.....	1
	E00-4501	WASHER 5/16 REGULAR AN960-516.....	2
26.	E00-2505	BOLT AN5-7A (5/16 X 7/8).....	2
27.	E27-1160	ROD END MALE 5/16".....	3
	E00-3501	NUT 5/16 JAM AN316-5R.....	3
28.	E27-8100	IDLER ARM WELDMENT.....	1
29.	E27-8300	CLUTCH TUBE WELDMENT.....	1
30.	E27-8410	O-RING, RED SILICONE 1/2 X 3/4.....	1
31.	E00-2508	BOLT AN5-11A (5/16 X 1-1/8).....	1
	E00-3500	NUT 5/16-24 FIBERLOCK AN365-524A.....	1
	E00-4501	WASHER 5/16 REGULAR AN960-516.....	2
32.	E27-8140	IDLER PULLEY ASSEMBLY.....	1
33.	E00-2410	BOLT AN4-16A (1/4 X 1-3/4).....	1
	E00-3402	NUT 1/4-28 FIBERLOCK AN365-428A.....	1
	E00-4401	WASHER 1/4 REGULAR AN960-416.....	2
34.	E00-2525	BOLT (5/16-24 X 2-1/4).....	1
	E00-3501	NUT 5/16 JAM AN316-5R.....	1
35.	E00-2524	NUT AN5-34A (5/16 X 3-1/2).....	2
	E00-3500	NUT 5/16-24 FIBERLOCK AN365-524A.....	2
	E00-4501	WASHER 5/16 REGULAR AN960-516.....	4
36.	E24-5110	UPPER ENGINE MOUNT CLEVIS.....	1
37.	E24-5100	UPPER ENGINE MOUNT CUP.....	1
38.	E00-6206	RIVET 1/8X 1/4 ALUM POP AAP-44.....	2
	E00-4100	WASHER 1/8 POP RIVET BACKUP ALUM.....	2
39.	E24-1611	RUBBER STRIP 1/4 X 1-1/2 X 7-1/2.....	1

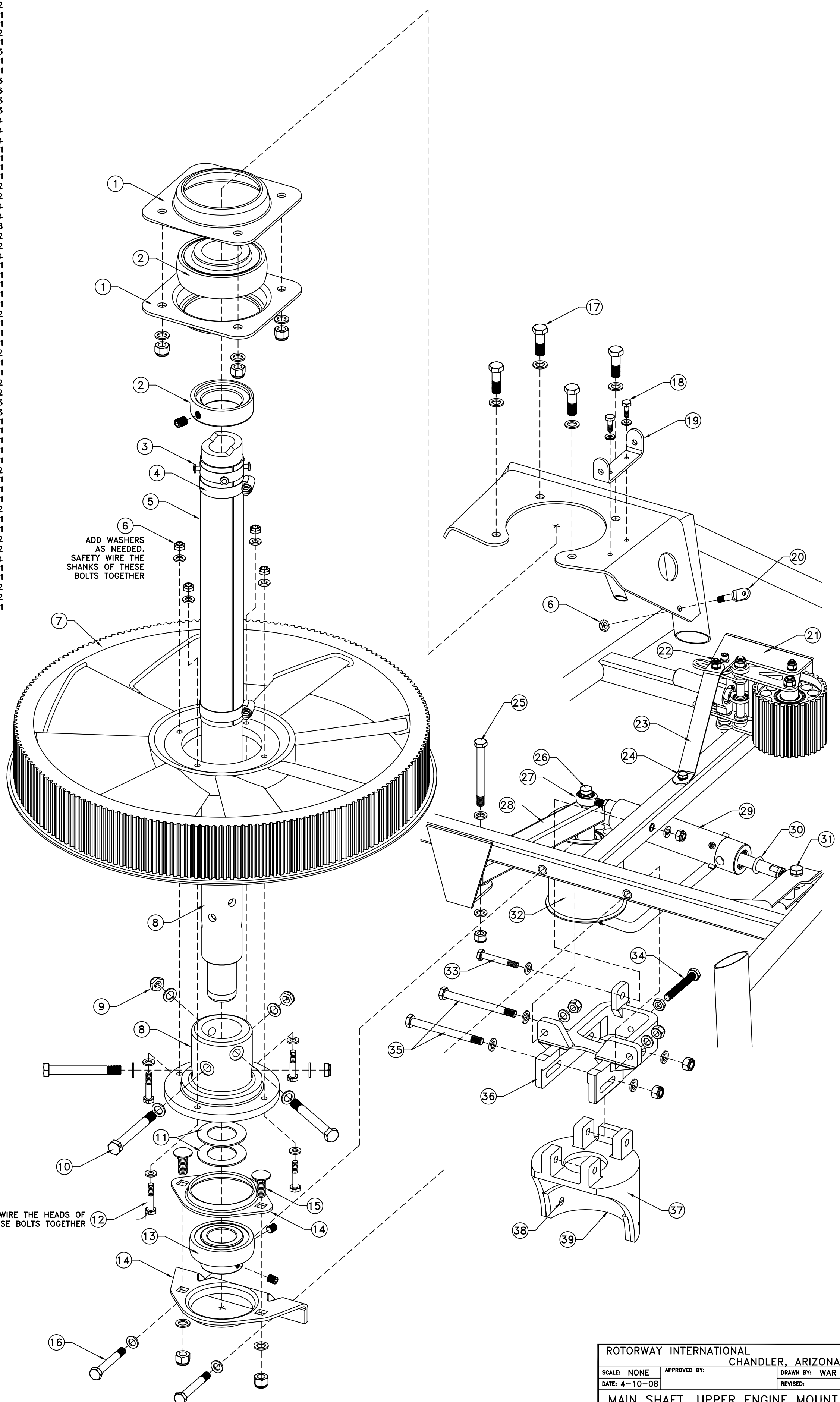

ADD WASHERS AS NEEDED. SAFETY WIRE THE SHANKS OF THESE BOLTS TOGETHER

SAFETY WIRE THE HEADS OF THESE BOLTS TOGETHER

ROTORWAY INTERNATIONAL CHANDLER, ARIZONA		
SCALE: NONE	APPROVED BY:	DRAWN BY: WAR
DATE: 4-10-08		REVISED:
<b>MAIN SHAFT, UPPER ENGINE MOUNT</b>		
MODEL: A600 TALON	DRAWING NUMBER: E49-2001	

A  
B  
C  
D  
E  
F  
G